

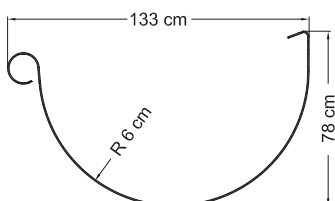

Gutters

25 cm half-round gutter with fold decorated with ivy leaves.



- Decorative and functional
- Elegance of details
- Compatible with the VMZ Pluviazinc® system
- Delivered in boxes of 5 different lengths, including discreet clips for installation.

1 clip every 40 cm to 50 cm.
Gutters compatible with
25 cm accessories from the
VMZINC® range.



| Designation | Aspect | Effective length (cm) | Spread out length (cm) |
|-----------------------|--------------|-----------------------|------------------------|
| Half-round gutter 501 | QUARTZ-ZINC® | 192 | 25 |

Curved gutters



Gutter

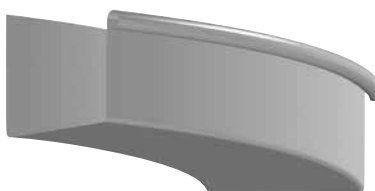

Box gutters

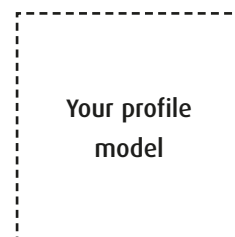

Other curved profiles

For curved profiles, please specify:

- type or aspect of metal
- extended width
- length
- with or without ring
- the radius R of the curve.

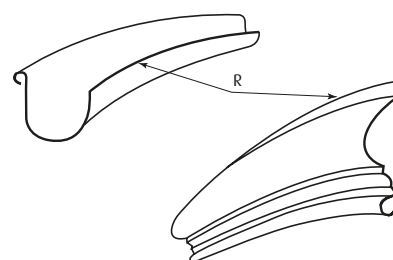



Referenced rainwater downpipes

Decorative pipes



4700



1873

Ribbed bends



2457

Dolphin bends



2458

Gargoyles



1148



2262

| Reference | Diameter in mm | Length or height *or section in mm |
|-----------|-------------------|---------------------------------------|
| 4700 | 140 x 90 | 1000 |
| 1873 | 80 | 1000 |
| | 100 | 1000 |
| 2457 | 80 | 72° bend |
| | 100 | 72° bend |
| 2458 | 80 | Dolphin bend |
| | 100 | Dolphin bend |
| 2458 | 80 | Offset 110 |
| | 100 | Offset 185 |
| 1148 | 60 | 200 |
| 2262 | 40 | 135 |
| | 80 | 280 |
| | 100 | 300 |



Hopper heads

Hopper head are very often the final signature to rain water system. Standard or bespoke, they will be an elegant link between the roof and the rain water pipes.



4707



2279



2286

| Reference | Diameter in mm | Length or height *or section in mm |
|-----------|----------------|---------------------------------------|
| 4407 | 800 | 250 x 77 + 104 + 104 + 104 + 77 |
| | 1000 | 280 93 + 116 + 116 + 116 + 93 |
| | 1200 | 300 x 117 + 124 + 124 + 124 + 117 |
| 2279 | 800 | 285 x 190 |
| | 1000 | 295 x 207 |
| | 1200 | 320 x 230 |
| 2286 | 800 | 240 x 170 |
| | 1000 | 300 x 210 |
| | 1200 | 345 x 240 |

Bespoke hopper head

